

Compact Hi-Wall Premier



ASTG09LVCC

Heating capacity: 3.4kW
 Heating efficiency: COP 4.66
 Cooling capacity: 2.5kW
 Cooling efficiency: EER 4.3



ASTG12LVCC

Heating capacity: 4.8kW
 Heating efficiency: COP 4.32
 Cooling capacity: 3.5kW
 Cooling efficiency: EER 3.8



ASTG14LUCB (Premier Plus)

Heating capacity: 5.4kW
 Heating efficiency: COP 3.67
 Cooling capacity: 4.2kW
 Cooling efficiency: EER 3.36



ASTG18LVCC

Heating capacity: 6.0kW
 Heating efficiency: COP 4.03
 Cooling capacity: 5.0kW
 Cooling efficiency: EER 3.27



ASTG22LVCC

Heating capacity: 7.2kW
 Heating efficiency: COP 3.55
 Cooling capacity: 6.3kW
 Cooling efficiency: EER 3.23



Full explanation of symbols on the back page

This extremely popular Heat Pump series is very compact with stylish flat panels outside and advanced engineering inside. Super energy savings are achieved with Fujitsu's improved heat exchange technology and the unit can also offer near silent operation, healthy fresh air filters and many extra features.

Compact design

Even the 7.0kW model is super compact.

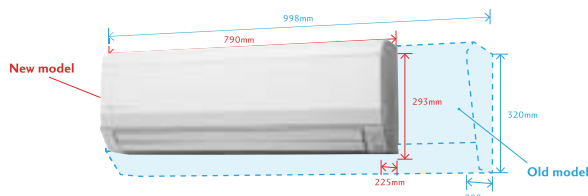

Super efficient

Higher energy efficiency has been achieved with Fujitsu's twin rotary DC compressor, DC Inverter control and DC fan motor technologies.

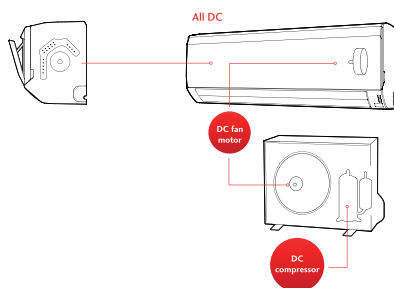

Healthy Air Filters

Fujitsu's advanced filter systems contribute to a fresher, cleaner and healthier living environment.



Fujitsu's Catechin Filters are approved by the Asthma and Respiratory Foundation NZ's Sensitive Choice® programme.



Fujitsu is recommended by Asthma New Zealand

Air Cleaning Filters

The Air Cleaning Filter uses static electricity to reduce fine particles and dust in the air, such as tobacco smoke, plant pollen and allergens that are too small to see.

Super quiet

ALL Fujitsu wall mounted models are equipped with 4 fan speeds including quiet fan mode, allowing the indoor units to operate as low as 21 decibels. In addition to this, Fujitsu's fan technology means that our models are quiet even when working their hardest to quickly heat or cool a room.

10°C heat operation

This function on the remote control will prevent the room temperature from falling below 10°C, so the room will never be too cold when you are away.

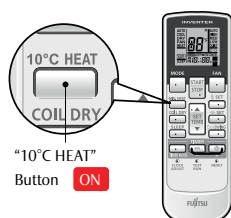

CONTROLLERS

Remote Controller (supplied)



- Four standard timers (On/Off/Program/Sleep timers).
- Easy operation.
- Easy to change modes: heating/cooling/dry/auto/fan.

Optional wall controllers

In addition to the standard remote controller (above), there are optional wall controllers available.

Programmable 7-day Timer



UTY-RVNYN

Universal Wall Controller

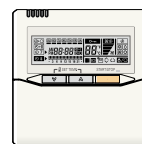

UTY-RNNYN

Simple Wall Controller



UTY-RSNNY

See page 5 for detailed features of each controller.

Optional wall controllers require the communication link (UTY-TWBXF1). Your accredited installer can install it for you.

Compact outside units too

Fujitsu's outside units set the industry standard for compact design, yet still deliver all the power required, with efficient airflow engineering that reduces noise. Fujitsu's outside heat exchange units are coated with a blue corrosion resistant material to enhance durability and help extend the performance life of your Heat Pump.

Model ASTG14LUCB

This 'Premier Plus' model includes the added energy saving features of a Human Sensor and 'set-and-forget' remote control.



Compact Hi-Wall specifications

Model No.	Indoor Unit		ASTG09LVCC	ASTG12LVCC	ASTG14LUCB	ASTG18LVCC	ASTG22LVCC	
	Outdoor Unit		AOTG09LVCC	AOTG12LVCC	AOTG14LUCB	AOTG18LVCC	AOTG22LVCC	
CAPACITY (RANGE)	HEAT	kW	3.4 (0.50 - 4.0)	4.8 (0.90 - 5.60)	5.4 (0.90 - 6.0)	6.0 (1.05 - 8.10)	7.2 (1.05 - 8.70)	
	COOL	kW	2.5 (0.50 - 3.30)	3.5 (0.90 - 4.0)	4.2 (0.90 - 5.0)	5.0 (0.90 - 5.80)	6.3 (0.90 - 7.30)	
INPUT POWER	HEAT/COOL	kW	0.73 / 0.58	1.11 / 0.92	1.47 / 1.25	1.49 / 1.53	2.03 / 1.95	
COP	HEAT	kW	4.66	4.32	3.67	4.03	3.55	
EER	COOL	kW	4.31	3.80	3.36	3.27	3.23	
STAR RATING	HEAT		4.5	4.0	2.5	3.5	2.5	
	COOL		4.0	3.0	2.0	2.0	2.0	
RUN CURRENT	HEAT/COOL	A	3.5 / 2.8	5.0 / 4.2	6.4 / 5.7	6.3 / 6.5	8.5 / 8.2	
MOISTURE REMOVAL		L/Hr	1.3	1.8	2.1	2.6	2.7	
INDOOR NOISE Q/L/M/H	HEAT	dB(A)	22/31/37/42	22/31/38/43	27/34/40/45	30/38/42/46	32/38/42/48	
OUTDOOR NOISE			47	48	50	53	56	
AIR CIRCULATION	INDOOR	l/s	225	239	264	267	267	
DIMENSIONS AND WEIGHTS (HxWxD)	INDOOR	mm	293 x 790 x 225			293 x 790 x 225		
		kg	9.5			10		
	OUTDOOR	mm	540 x 660 x 290		540 x 790 x 290		620 x 790 x 290	
		kg	25	34	37	40		
OUTDOOR OPERATING TEMPERATURE	HEAT	Degree	-15 to 24					
	COOL		10 to 46					
REFRIGERANT			R410a					